

Bölsche Strasse 53a

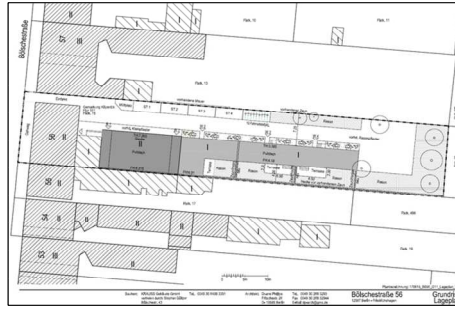

This traditional Remise ensemble consists of an historical Ballhaus and its bowling alley. Over the years the buildings were converted into other uses and their facades altered.

Working closely with the preservation authority, the buildings will be converted into a series of small, affordable flats with gardens to the back. The courtyard will be resurfaced with cobblestones, potted plants and small wrought-iron fences will create an atmosphere in the front similar to traditional Mews in London.

