

Bernhard-Lichtenberg-Strasse

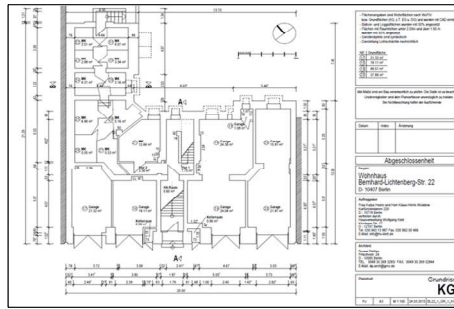

The manner in which rentable space was calculated in the former East Germany is very different from today's method. The current housing management requested that we conduct a measured survey of each flat in order to verify the actual square meterage.

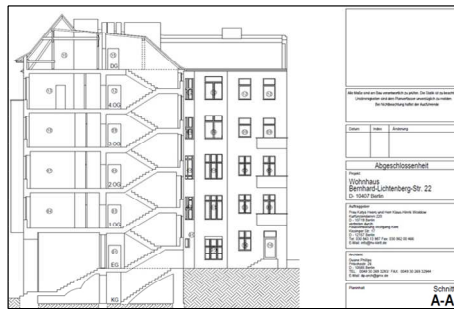

Appointments were made with each renter and over a period of three days we conducted the measurements of their apartments. The results were documented in tables and measured drawings were also prepared to support an official 'Abgeschlossenheitsbescheinigung' (certificate documenting the floor plan, façade, and number of square meters of each flat) as required by law.

